

Network PTZ Cameras

Quick Guide

V3.01

Waterproof Requirements

Please waterproof cables in accordance with the following instructions. User shall assume all responsibility for device damage caused by water due to improper waterproof measures.



NOTE!

- Before you start, connect all the needed cables and cut off the copper wires for the cables that you don't use.
- Please use self-adhesive waterproof tape (supplied with some products) to protect the cables.
- Use waterproof components to protect the network cable. Waterproof the power cable separately if you don't use it. The video cable does not need waterproof treatment.

1. Use insulation tape (not included in the package) to insulate the connection part of each cable.

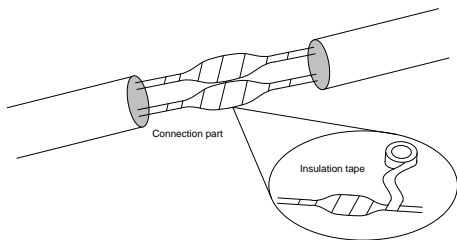

2. Waterproof the cables with self-adhesive waterproof tape.
 - (1) Fully stretch the waterproof tape at both ends.
 - (2) Wrap the connection part and the cable ends tightly with waterproof tape. Make sure the tape is fully stretched during the process.
 - (3) Tighten the tape at both ends to prevent water leakage.

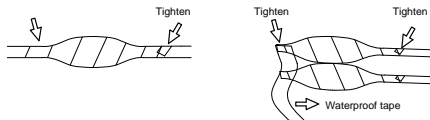

Wrap the unused cables together into a bundle

3. Install the supplied waterproof components to the network cable in sequence.

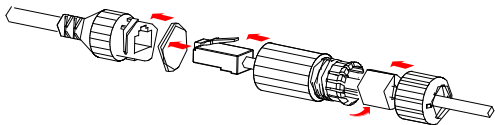

i CAUTION!

You need to mount the rubber ring onto the network cable interface first.

4. If your camera has a DC cable and you will not use it, insert the plug into the interface.

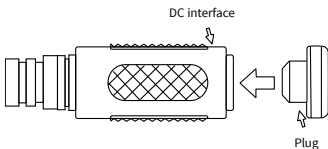

5. (Optional) After the waterproof treatment is completed, put the cables into a waterproof junction box (purchased separately).

i CAUTION!

- The cable connector must not be exposed and must be kept away from water.
- Restore and fasten the device after dismounting.
- Place the power adapter in a power distribution box.

1 Packing List

Contact your local dealer if the package is damaged or incomplete. The package contents may vary with device model.

No.	Name	Qty	Unit
1	Camera	1	PCS
2	Power adapter	1	PCS
3	User manual	1	Set
4	Accessory pack	1	Set

2 Safety Information

2.1 Installation

- Do not use this device in extreme high temperature or humidity. Keep the device away from heat sources such as heaters, stoves, etc., and prevent interference from electromagnetic radiation.
- The installation platform must be able to withstand at least 8 times the weight of the camera and accessories. Make sure the bracket is stabilized and away from vibration sources. Avoid camera drop or image shake due to unstable platform.
- Take anti-collision measures during installation. Take the camera base center as the circle center, there must be no interference within the diameter of 0.8m to avoid collision.
- The installation platform must be at least 250mm x 250mm.
- The camera must be installed on a horizontal surface. The level of the device helps determine whether the surface is horizontal: If the bubble is in the center, the surface is horizontal; otherwise the surface is inclined.
- Leading tail cables downward or through the side cable slot are both supported.
- Accessories like wall mount bracket are needed. Please purchase the accessories according to the recommendation list.
- Do not hold the tail cable by hand for weight bearing. Otherwise, the cable connector of the camera could be loosened.
- Make sure to connect the camera and the power adapter before connecting power. DO NOT connect the adapter to power before connecting it to the device. DO NOT unplug the camera power cord with the adapter connected to power.

- Lightning measures are required if the camera is to be mounted on a high position.
- Never look at the laser while the power is on. Make sure power is disconnected when checking laser device with your eyes.
- Whether in use or not, do not aim the camera lens at a strong light source such as sun or incandescent lamp. The strong light can cause fatal damage to the camera.
- Make sure that the high level of alarm input is under 5V DC.
- When connecting to an external interface, use an existing connection terminal, and ensure that the cable terminal (latch or clamp) is in good condition and properly fastened. Ensure that the cable is not tense during mounting, with a proper margin reserved to avoid poor port contact or loosening caused by shock or shake. Protect the power cables, plugs, and sockets so they won't be accidentally stepped on or pressed.
- The device must be properly grounded through the grounding terminal.
- The connectors of the tail cable must not be exposed. The bar cavity, junction box, corrugated pipe and PVC pipe must be fully sealed to protect the connectors from water. The waterproof components for the RJ45 plug must be used properly to protect the network cable from water.
- Insulate all exposing cables before connecting power to avoid short circuit.
- During installation, do not overbend the tail cables (including power cable and network cable).
- To avoid damage, do not apply excessive force to the device components, for example, pulling the wiper.
- After installation, if the camera is not in use, connect the camera to power and turn it vertically to the position of -90 degree (i.e. keep the glass window vertically downward).

2.2 Maintenance

- If there is dust on the front glass surface, remove the dust gently using an oil-free brush or a rubber dust blowing ball.
- If there is grease or a dust stain on the front glass surface, clean the glass surface gently from the center outward using lens cleaning cloth. If the grease or the stain still cannot be removed, use lens cleaning cloth dipped with detergent and clean the glass surface gently until it is removed.
- Do not use organic solvents, such as benzene or ethanol, to clean the transparent dome cover.

3 Introduction

3.1 Dimensions

The figures in the manual are for your reference only. The actual appearance may vary with the product model.

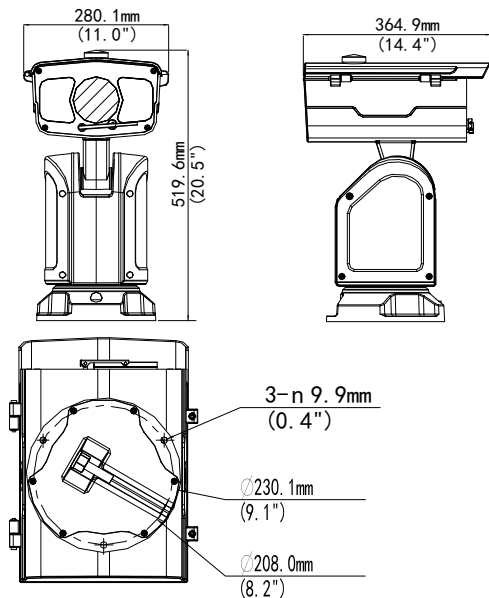

3.2 Cable Connection

The appearance and tail cable may vary with device model. The following part shows an example.



NOTE!

For specifications, see the latest product datasheets.

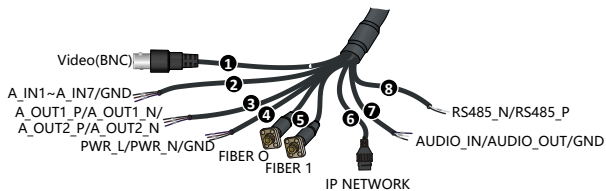

1. Video output	2. Alarm input 1-7
3. Alarm output 1_P /Alarm output 1_N /Alarm output 2_P /Alarm output 2_N	4. Power cable
5. Fiber 0/Fiber 1	6. Network cable
7. Audio input/Audio output/GND	8. RS485_N/RS485_P

4 Installation

4.1 Lightning Protection

Lightning protection measures are applied to the device's board to offer lightning and surge protection. If the device is to be installed on a high position, extra lightning protection measures like external lightning arrestors are required.

- The lightning arrestor must meet requirements: 48V DC rated voltage, and at least 10kA nominal discharge current.
- Signal transmission lines must be at least 50 meters away from high-voltage equipment or cables.
- For outdoor installation, route the cables along eaves.
- For cameras in open area, bury the cables with metal pipes covered, and ground the metal pipe at a single point.

- During outdoor installation, take necessary safety measures while guaranteeing electrical safety, and use arrestors to protect the power as required.
- In thunderstorm or high-induced-voltage areas (for example, near a high voltage substation), an extra high power lightning arrestor and lightning rod are required.
- The lightning protection and grounding design for outdoor installation must meet the requirements of structure lightning protection, as well as relevant national and industrial standards.
- An equipotential grounding system is required. The grounding system must meet the requirements of anti-interference and electrical safety, and should not be short-connected or mixed with zero lines of a strong grid. If the system is grounded alone, the grounding impedance should be no greater than 4Ω , and the cross sectional area of the grounding cable must be no less than 25 mm^2 .

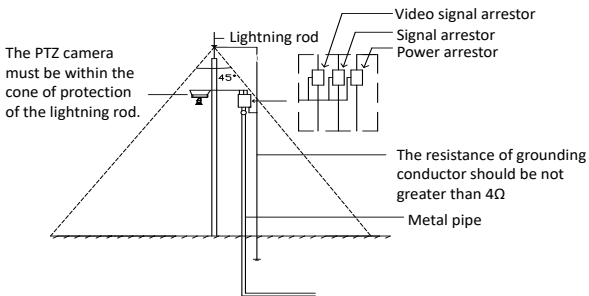

4.2 (Optional) Install Optical Module

The modules inside the camera have been connected. You need to mount the optical module (purchased separately) before use.



WARNING!

- Select the optical module according to environment temperature. For outdoor use, choose SFP optical modules that support an ambient temperature of above 85°C.
- To avoid damage, do not overbend the optical fiber.
- Do not disassemble the device in high humidity environment, the high humidity inside the device will cause lens fogging.

1. Unscrew the six screws and remove the base plate.

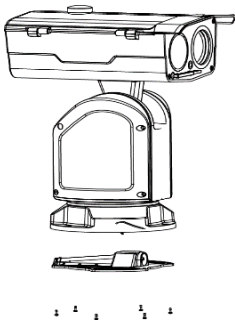

2. Insert the SFP optical module.

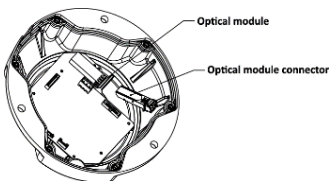

3. Insert the optical fiber.

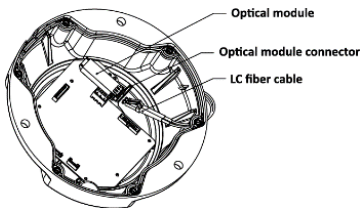

Note:

When using a single-fiber optical module, please connect the optical module to the external network switch using the same fiber optic cable (e.g., if you use the

FIBER, 0 cable to connect the optical module, you must also use the FIBER, 0 cable to connect to the network switch).

4.3 (Optional) Install SD Card

You need to install a Micro SD card first if you want to save video on an on-board SD card.



NOTE!

- You need to format the Micro SD card before use. The Micro SD card can be formatted on the camera's Web interface.
- For recommended SD card specifications, please contact your dealer or technical support.

The figure below is for illustrative purpose only. The actual card slot position may vary.



WARNING!

- Before you insert or remove the Micro SD card, be sure to disconnect power and wait till the camera stops operation; otherwise, the camera or the Micro SD card may be damaged.
- Do not disassemble the device in high humidity environment. The high humidity inside the device will cause lens fogging.

1. Remove the two screws from the upper cover.
2. Insert the Micro SD card into the slot.
3. Check that the sealing ring is in position.
4. Place the upper cover back in place, and use a hex key to turn the screws until they are fully tightened.



WARNING!

- Please make sure that the sealing ring and the upper cover is in place, and the screws are fully tightened. Otherwise, water intrusion may cause device damage.
- Our company shall not assume any responsibility for device damage caused by improper installation.

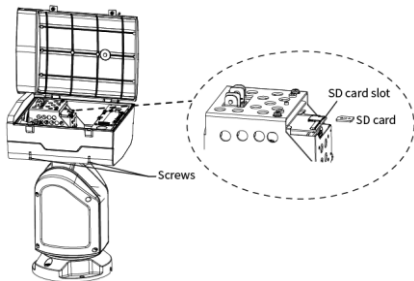

4.4 Install Camera



NOTE!

- If you want to mount the camera on a high position, power on the camera and check camera functions before mounting.
- Before installing the camera on a pole, make sure that the pole can support the weight of the camera to prevent the pole from shaking.

With a bracket

1. Align the three holes in the base of the device with those of the bracket.

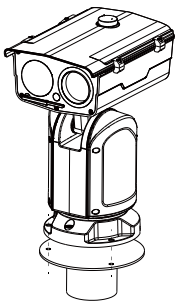

2. Insert three bolts into the corresponding hole from top to bottom of the camera base, thread the flat washer, spring washer, and nut into the bolt in turn, and tighten the nut with a wrench until it reaches the limit.

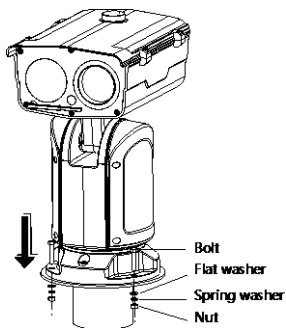

Caution:

- Do not insert bolts from the bottom to the top of the camera base, otherwise the user will be fully responsible for the device damage caused by improper installation.
- The flat washer and spring washer are required during the installation, otherwise the bolt components may be loose.

3. Complete the camera installation.

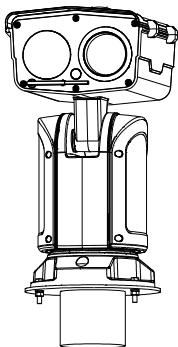

Without a bracket

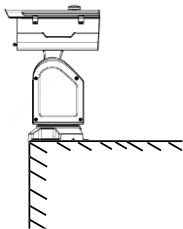

5 Startup

After the device is properly installed, follow the steps to start up the device.

1. Connect the camera and the power adapter before connecting power.



WARNING!

DO NOT connect the adapter to power before connecting it to the device.

2. Connect power.



NOTE!

Recommended power supply: DC 48V, 3A or AC 24V, 5A.



WARNING!

DO NOT unplug the camera power cord with the adapter connected to power.

3. Wait till the device completes self-test, and then operate the camera.



NOTE!

The camera performs a self-test every time it's powered on, including each of the pan, tilt and zoom operations.

6 Web Login

Log in to the Web interface to manage and maintain the device.

1. Open your browser, input the camera's IP address **192.168.1.13** in the address bar and then press **Enter** to open the login page.
 2. Enter the username and password (**admin/123456** by default) and then click **Login**.
-



NOTE!

- DHCP is enabled by default. If a DHCP server is deployed in the network, the IP address of your camera may be assigned dynamically, and you need to use the assigned IP address to log in.
 - If prompted, install the plug-in at your first login. Please follow the on-screen instructions to complete the installation and then open the browser again to log in.
 - The default password is intended only for your first login. To ensure security, please change the password after your first login. You are strongly recommended to set a strong password of at least nine characters including all three elements: digits, letters and special characters.
 - If the password has been changed, please use the new password to log in.
-

7 FAQ

1. Failed to install the plug-in?

Answer: Before you log in, follow the steps to add the camera's IP to the trusted sites in your IE: Click **Tool > Internet Options > Security**. Click **Trusted sites**, click **Sites**, and then add the camera's IP address.

If you are using Windows 7, you also need to save the setup.exe to your computer first, and then right-click the file and select **Run as administrator**.

2. No live video after my first login?

Answer: Please turn off the firewall on your computer and then log in again.

3. How to restore factory default settings?

Remove the back cover, use a pointed object like a toothpick or paper clip to press and hold the RST button for 15 seconds to restore defaults. The reset button only works within 10 minutes after the camera is powered on.

Disclaimer and Safety Warnings

Copyright Statement

No part of this manual may be copied, reproduced, translated or distributed in any form by any means without prior content in writing from our company (referred to as us hereafter).

The product described in this manual may contain proprietary software owned by our company and its possible licensors. Unless permitted, no one is allowed to copy, distribute, modify, abstract, decompile, disassemble, decrypt, reverse engineer, rent, transfer, or sublicense the software in any form by any means.

Export Compliance Statement

Our company complies with applicable export control laws and regulations worldwide, including that of the People's Republic of China and the United States, and abides by relevant regulations relating to the export, re-export and transfer of hardware, software and technology. Regarding the product described in this manual, our company asks you to fully understand and strictly abide by the applicable export laws and regulations worldwide.

Privacy Protection Reminder

Our company complies with appropriate privacy protection laws and is committed to protecting user privacy. You may want to read our full privacy policy at our website and get to know the ways we process your personal information. Please be aware, using the product described in this manual may involve the collection of personal information such as face, fingerprint, license plate number, email, phone number, GPS. Please abide by your local laws and regulations while using the product.

About This Manual

- This manual is intended for multiple product models, and the photos, illustrations, descriptions, etc, in this manual may be different from the actual appearances, functions, features, etc, of the product.
- This manual is intended for multiple software versions, and the illustrations and descriptions in this manual may be different from the actual GUI and functions of the software.
- Despite our best efforts, technical or typographical errors may exist in this manual. Our company cannot be held responsible for any such errors and reserves the right to change the manual without prior notice.
- Users are fully responsible for the damages and losses that arise due to improper operation.
- Our company reserves the right to change any information in this manual without any prior notice or indication. Due to such reasons as product version upgrade or regulatory requirement of relevant regions, this manual will be periodically updated.

Disclaimer of Liability

- To the extent allowed by applicable law, in no event will our company be liable for any special, incidental, indirect, consequential damages, nor for any loss of profits, data, and documents.

- The product described in this manual is provided on an "as is" basis. Unless required by applicable law, this manual is only for informational purpose, and all statements, information, and recommendations in this manual are presented without warranty of any kind, expressed or implied, including, but not limited to, merchantability, satisfaction with quality, fitness for a particular purpose, and noninfringement.
- Users must assume total responsibility and all risks for connecting the product to the Internet, including, but not limited to, network attack, hacking, and virus. We strongly recommends that users take all necessary measures to enhance the protection of network, device, data and personal information. Our company disclaims any liability related thereto but will readily provide necessary security related support.
- To the extent not prohibited by applicable law, in no event will our company and its employees, licensors, subsidiary, affiliates be liable for results arising out of using or inability to use the product or service, including, not limited to, loss of profits and any other commercial damages or losses, loss of data, procurement of substitute goods or services; property damage, personal injury, business interruption, loss of business information, or any special, direct, indirect, incidental, consequential, pecuniary, coverage, exemplary, subsidiary losses, however caused and on any theory of liability, whether in contract, strict liability or tort (including negligence or otherwise) in any way out of the use of the product, even if our company has been advised of the possibility of such damages (other than as may be required by applicable law in cases involving personal injury, incidental or subsidiary damage).
- To the extent allowed by applicable law, in no event shall our total liability to you for all damages for the product described in this manual (other than as may be required by applicable law in cases involving personal injury) exceed the amount of money that you have paid for the product.

Network Security

Please take all necessary measures to enhance network security for your device.

The following are necessary measures for the network security of your device:

- **Change default password and set strong password:** You are strongly recommended to change the default password after your first login and set a strong password of at least nine characters including all three elements: digits, letters and special characters.
- **Keep firmware up to date:** It is recommended that your device is always upgraded to the latest version for the latest functions and better security. Visit our official website or contact your local dealer for the latest firmware.

The following are recommendations for enhancing network security of your device:

- **Change password regularly:** Change your device password on a regular basis and keep the password safe. Make sure only the authorized user can log in to the device.
- **Enable HTTPS/SSL:** Use SSL certificate to encrypt HTTP communications and ensure data security.
- **Enable IP address filtering:** Allow access only from the specified IP addresses.
- **Minimum port mapping:** Configure your router or firewall to open a minimum set of ports to the WAN and keep only the necessary port mappings. Never set the device as the DMZ host or configure a full cone NAT.

- **Disable the automatic login and save password features:** If multiple users have access to your computer, it is recommended that you disable these features to prevent unauthorized access.
- **Choose username and password discretely:** Avoid using the username and password of your social media, bank, email account, etc, as the username and password of your device, in case your social media, bank and email account information is leaked.
- **Restrict user permissions:** If more than one user needs access to your system, make sure each user is granted only the necessary permissions.
- **Disable UPnP:** When UPnP is enabled, the router will automatically map internal ports, and the system will automatically forward port data, which results in the risks of data leakage. Therefore, it is recommended to disable UPnP if HTTP and TCP port mapping have been enabled manually on your router.
- **SNMP:** Disable SNMP if you do not use it. If you do use it, then SNMPv3 is recommended.
- **Multicast:** Multicast is intended to transmit video to multiple devices. If you do not use this function, it is recommended you disable multicast on your network.
- **Check logs:** Check your device logs regularly to detect unauthorized access or abnormal operations.
- **Physical protection:** Keep the device in a locked room or cabinet to prevent unauthorized physical access.
- **Isolate video surveillance network:** Isolating your video surveillance network with other service networks helps prevent unauthorized access to devices in your security system from other service networks.

Safety Warnings

The device must be installed, serviced and maintained by a trained professional with necessary safety knowledge and skills. Before you start using the device, please read through this guide carefully and make sure all applicable requirements are met to avoid danger and loss of property.

Storage, Transportation, and Use

- Store or use the device in a proper environment that meets environmental requirements, including and not limited to, temperature, humidity, dust, corrosive gases, electromagnetic radiation, etc.
- Make sure the device is securely installed or placed on a flat surface to prevent falling.
- Unless otherwise specified, do not stack devices.
- Ensure good ventilation in the operating environment. Do not cover the vents on the device. Allow adequate space for ventilation.
- Protect the device from liquid of any kind.
- Make sure the power supply provides a stable voltage that meets the power requirements of the device. Make sure the power supply's output power exceeds the total maximum power of all the connected devices.
- Verify that the device is properly installed before connecting it to power.
- Do not remove the seal from the device body without consulting **our company** first. Do not attempt to service the product yourself. Contact a trained professional for maintenance.
- Always disconnect the device from power before attempting to move the device.
- Take proper waterproof measures in accordance with requirements before using the device outdoors.

Power Requirements

- Installation and use of the device must be in strict accordance with your local electrical safety regulations.
- Use a UL certified power supply that meets LPS requirements if an adapter is used.
- Use the recommended cordset (power cord) in accordance with the specified ratings.
- Only use the power adapter supplied with your device.
- Use a mains socket outlet with a protective earthing (grounding) connection.
- Ground your device properly if the device is intended to be grounded.

Battery Use Caution

- When battery is used, avoid:
 - High or low extreme temperatures during use, storage and transportation;
 - Extremely low air pressure, or low air pressure at high altitude.
 - Battery replacement.
- Use the battery properly. Improper use of the battery such as the following may cause risks of fire, explosion or leakage of flammable liquid or gas.
 - Replace battery with an incorrect type;
 - Dispose of a battery into fire or a hot oven, or mechanically crushing or cutting of a battery;
- Dispose the used battery according to your local regulations or the battery manufacturer's instructions.

Avertissement de l'utilisation de la batterie

- Lorsque utiliser la batterie, évitez:
 - Températures extrêmement élevées ou basses pendant l'utilisation, le stockage et le transport;
 - Pression d'air extrêmement basse, ou pression d'air basse à haute altitude;
 - Remplacement de la batterie.
- Utilisez la batterie correctement. Mauvaise utilisation de la batterie comme celles mentionnées ici, peut entraîner des risques d'incendie, d'explosion ou de fuite liquide de gaz inflammables.
 - Remplacer la batterie par un type incorrect;
 - Disposer d'une batterie dans le feu ou un four chaud, écraser mécaniquement ou couper la batterie;
- Disposer la batterie utilisée conformément à vos règlements locaux ou aux instructions du fabricant de la batterie.
- **Personal safety warnings:**
 - Chemical Burn Hazard. This product contains a coin cell battery. Do not ingest battery. If the coin cell battery is swallowed, it can cause severe internal burns in just 2 hours and can lead to death.
 - Keep new and used batteries away from children.
 - If the battery compartment does not close securely, stop using the product and keep it away from children.
 - If you think batteries might have been swallowed or placed inside any part of the body, seek immediate medical attention.
- **Avvertissements de sécurité personnelle:**

- Risque de brûlure chimique. Ce produit contient une batterie de cellules. N'ingérer pas la batterie. Si la batterie de cellule est avalée, elle peut causer de graves brûlures internes en seulement 2 heures et peut entraîner la mort.
- Gardez les batteries nouvelles ou utilisées à l'écart des enfants.
- Si le compartiment de la batterie ne se ferme pas en toute sécurité, cessez d'utiliser le produit et gardez-le à l'écart des enfants.
- Si vous pensez que des piles ont pu être avalées ou placées à l'intérieur d'une partie du corps, consultez immédiatement un médecin.

Regulatory Compliance

FCC Statements

This device complies with Part 15 of the FCC Rules. Operation is subject to the following two conditions: (1) this device may not cause harmful interference, and (2) this device must accept any interference received, including interference that may cause undesired operation.

Caution: The user is cautioned that changes or modifications not expressly approved by the party responsible for compliance could void the user's authority to operate the equipment.

NOTE: This equipment has been tested and found to comply with the limits for a Class A digital device, pursuant to part 15 of the FCC Rules. These limits are designed to provide reasonable protection against harmful interference when the equipment is operated in a commercial environment. This equipment generates, uses, and can radiate radio frequency energy and, if not installed and used in accordance with the instruction manual, may cause harmful interference to radio communications. Operation of this equipment in a residential area is likely to cause harmful interference in which case the user will be required to correct the interference at his own expense.

LVD/EMC Directive



This product complies with the European Low Voltage Directive 2014/35/EU and EMC Directive 2014/30/EU.

WEEE Directive–2012/19/EU



The product this manual refers to is covered by the Waste Electrical & Electronic Equipment (WEEE) Directive and must be disposed of in a responsible manner.

Battery Regulation- (EU) 2023/1542



Battery in the product complies with the European Battery Regulation (EU) 2023/1542. For proper recycling, return the battery to your supplier or to a designated collection point.