

4-Bay Desktop NAS

Quick Guide

1 Packing List

Contact your local dealer if the package is damaged or incomplete. The package contents may vary with device model.

No.	Name	Qty	Unit
1	NAS device	1	PCS
2	Pan head screws (for M.2 SSD)	3	PCS
3	Countersunk head screw (for 2.5" SATA disk)	17	PCS
4	Power adapter	1	PCS
5	Power cable	1	PCS
6	Network cable	2	PCS
7	Enclosure key	2	PCS
8	Product documents	1	Set

2 Appearance

The appearance may vary with device model. The figure below is for illustrative purpose only.

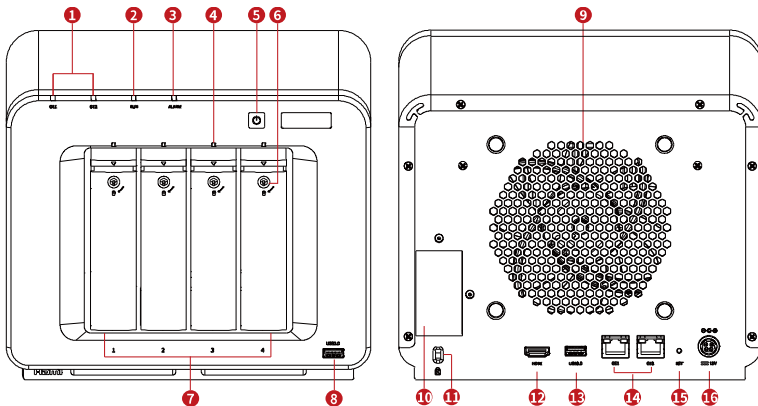

No.	Name	Description
①	Network status indicators (GE1/GE2)	<p>Indicates network connection status.</p> <ul style="list-style-type: none"> • Blinking green: The device is sending/receiving data. • Steady green: No data sending/receiving. • Off: The device is turned off, or network cable is not connected.
②	System status indicator (RUN)	<p>Indicates system operation status.</p> <ul style="list-style-type: none"> • Blinking green: The device is starting up. • Steady green: The device is running normally. • Off: The device is turned off.
③	Alarm indicator (ALARM)	<p>Indicates system alarms, such as fan fault, high temperature.</p> <ul style="list-style-type: none"> • Steady red: An alarm has occurred. • Off: No alarm.
④	Hard disk indicator	<p>Indicates the status of each hard disk.</p> <ul style="list-style-type: none"> • Blinking green: The disk is reading/writing data. • Steady green: No data reading/writing. • Steady yellow: An exception has occurred. • Off: The device is turned off, or no hard disk is inserted.
⑤	Power button	<ul style="list-style-type: none"> • A quick press turns on/off the device. • Press and hold the button for at least 5s to turn off the device by force. <p>The button is integrated with an indicator, which is lit when the device is operating, and is off when the device is turned off.</p>
⑥	Enclosure key hole	Used to lock/unlock the enclosure using the supplied key.

No.	Name	Description
⑦	Hard disk bay	4 bays for 3.5" or 2.5" SATA disks (HDD or SSD).
⑧	Front USB3.0	Connects a USB device (such as hard disk, flash drive).
⑨	Fan	Used for heat dissipation.
⑩	PCIe expansion slot	For PCIe card expansion (such as 10GE NIC).
⑪	Kensington lock slot	Allows the device to be physically secured.
⑫	HDMI	Connects a high definition display device.
⑬	Rear USB3.0	Connects a USB device (such as hard disk, flash drive).
⑭	Network Interface	2 x RJ45, 10M/100M/1000M auto-adaptation.
⑮	Reset button	Press and hold for at least 5 seconds to restore factory defaults: <ul style="list-style-type: none"> • GE1 port: Obtains IP automatically via DHCP. • GE2 port: Default IP (192.168.0.1). • admin user: Default password (admin) and default permissions.
⑯	DC 12V input interface	Connects to an AC power supply via a power adapter for power supply.

3 Device Installation

3.1 Preparation

- Purchase the following accessories as needed.

Name	Description
2.5" or 3.5" SATA disk (HDD or SSD)	Max 4 disks. Note: If you plan to create RAID, it is recommended to choose disks of the same capacity to maximize space usage.
M.2 NVMe 2280 SSD	Max 2 disks.
DDR4 SODIMM memory	Max 2 memories. Note: One memory is pre-installed. You may add one more or replace the current one for expansion. Up to 32GB is allowed.
PCIe card (such as 10GE NIC)	Only one is allowed. Note: Please use a low-profile PCIe card.

- A cross screwdriver will be needed during the installation.

3.2 Install SATA Disk

1. Open and remove the front panel.

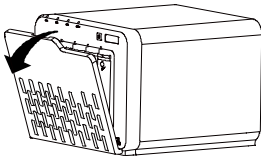

2. Press the snap button on the top of the disk enclosure to open the handle.

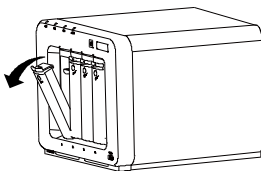

3. Pull out the enclosure horizontally.

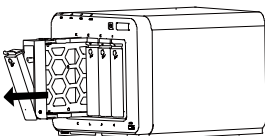



CAUTION!

If the enclosure is locked, use the supplied key to unlock it first and then open the handle.

4. Install the hard disk into the enclosure.

- 3.5" disk

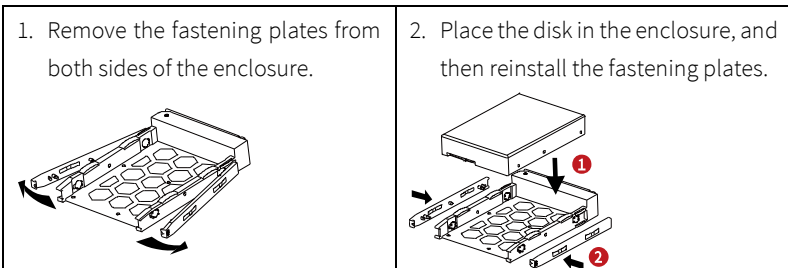

- 2.5" disk

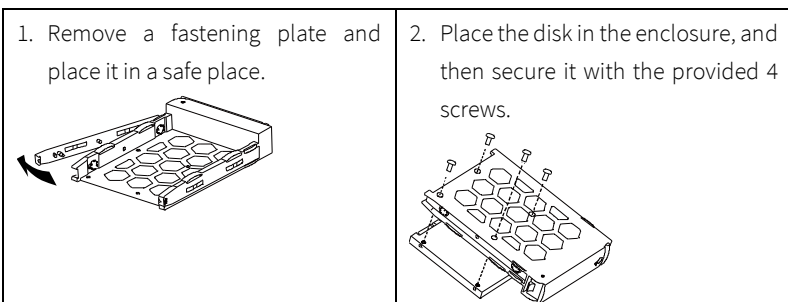

5. Insert the enclosure into the bay horizontally.

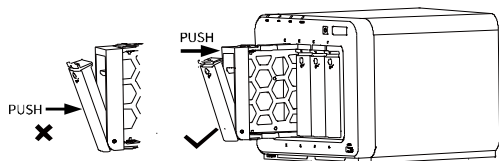

6. Close the enclosure handle.

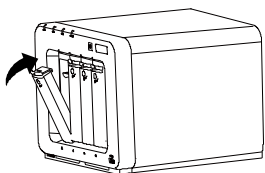



CAUTION!

- Be sure to disconnect the device from power before installing or replacing disks.
 - Be sure to insert all 4 enclosures (including the empty ones); otherwise, it will cause loud noise and lead to uneven heat dissipation which may cause device damage.
 - After inserting the enclosures, it is recommended to lock them using the supplied key to prevent illegal physical access.
-

7. Reinstall the front panel to protect the bays from dust.

3.3 (Optional) Install M.2 SSD or Memory

**CAUTION!**

Be sure to disconnect the device from power before installing or replacing the SSD or memory.

Loosen the 2 screws (circled in the figure below) on the RAM&SSD cover at the bottom of the device, and then remove the cover.

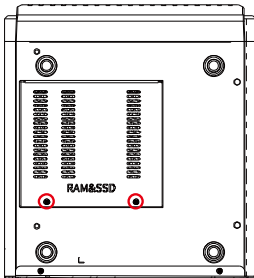

Install M.2 SSD

1. Align the notch on the SSD with the notch in the slot, and then insert the SSD into the slot at an angle.

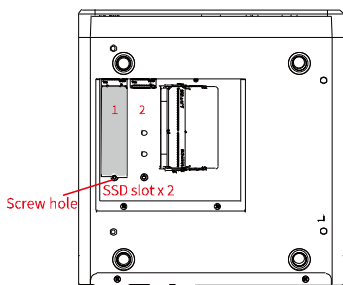

2. Gently press down on the raised end of the SSD, and then secure it by inserting a screw into the screw hole.

Install Memory

1. Align the notch on the mental connector of the memory with the notch in the slot, and then insert the memory into the slot at an angle.

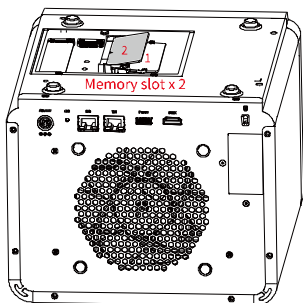

2. Gently press down on the raised end of the memory until it clicks in place.

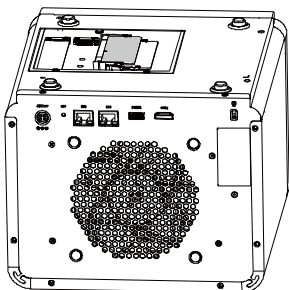

Reinstall the cover, and then fasten the 2 screws.

3.4 (Optional) Install PCIe Card



CAUTION!

Be sure to disconnect the device from power before installing or replacing the PCIe card.

1. Loosen the 6 screws (circled in the figure below) fastening the outer cover on the rear panel, and then remove the outer cover.

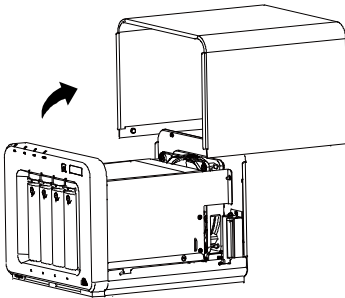
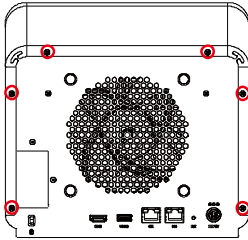

2. Loosen the screw on the PCIe filler panel, and then remove the filler panel.

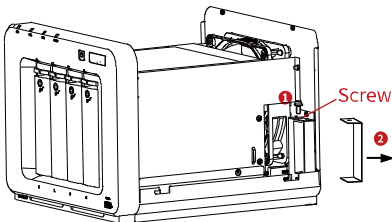

3. Insert the PCIe card into the slot, and then insert the screw and fasten it.

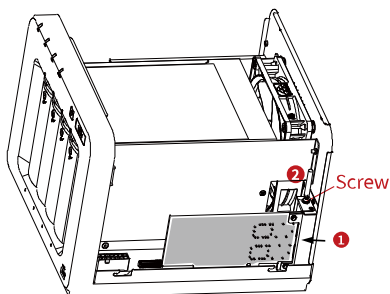

4. Reinstall the outer cover, and then tighten the 6 screws.

4 Device Management

GE1 port: Obtains IP automatically via DHCP.

GE2 port: Default IP (192.168.0.1).

For GE1 and GE2 ports, the initial configuration procedures differ. Please follow the instructions in [Use GE1 Port](#) or [Use GE2 Port](#) to start up the device and complete the initial setup.

4.1 Use GE1 Port (Recommended)

4.1.1 Connect Device to Network

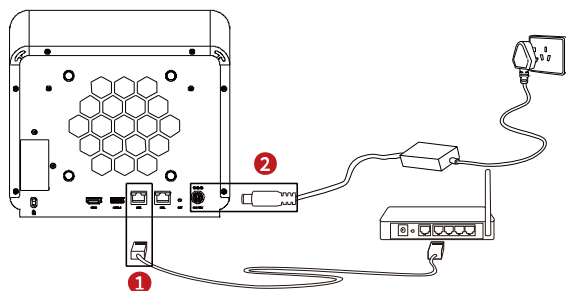

1. Connect the **GE1 port (left)** to the router with a network cable.
2. Connect the power cable.

(1) Connect the power adapter to the device's power input interface, making sure the side with an arrow is facing up.



- (2) Connect one end of the power cable to the power adapter, and connect the other end to the AC power socket.
3. After connecting power, press the power button on the device. The power button is lit, which means the device is turned on.

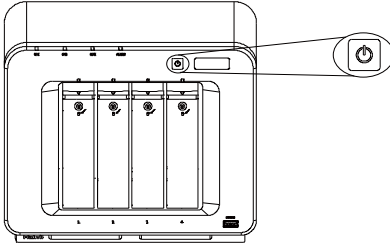

NOTE!

To turn off the device, press the power button once.

4.1.2 Initial Setup

Choose a method to complete the initial setup of the NAS.

1 Manage in App (Recommended)

Log In

1. Connect your mobile phone to the router's Wi-Fi network.
2. Scan the QR code below with your mobile phone to download and install the UniDrive app.



3. Open the app, select **Account Login**, and then enter your account and password.
If you don't have an account, tap **Sign Up** to register an account first.

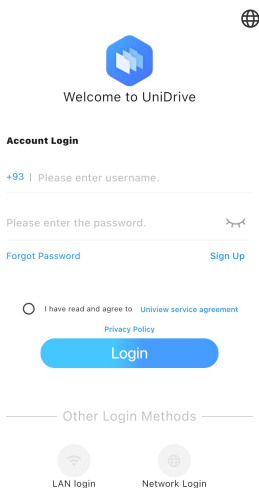

4. Read and agree to the service agreement and privacy policy, and then tap **Login**.

- Other Login Methods

- (1) **Network Login**: Enter the NAS device's username and password, public network IP, and port (default: 80) to log in.
- (2) **LAN Login**: The app will discover NAS devices on the same LAN as your mobile phone. Tap a device and enter the NAS device's username and password to log in.



NOTE!

For the first time login, the default username/password is admin/admin. It is recommended to change the default password to a strong password: at least 9 characters including uppercase and lowercase letters, digits, and special characters. When changed, please use the modified password to log in.

Add Device

If you are **logged in with an account**, tap **Add device**, and then you can choose a method to add devices.



NOTE!

- One user can bind multiple devices.
- One device can only be bound to one user.
- The first user who binds the device becomes the owner of it and can share the device with other users.

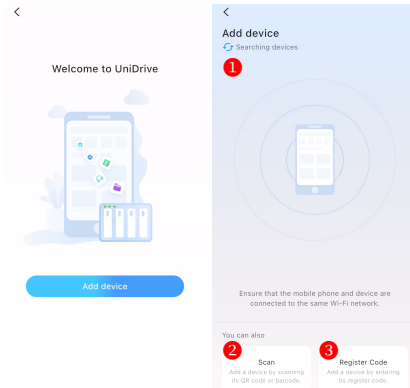

Method 1: Discover and add devices on the same LAN as your mobile phone.

Method 2: Scan the QR code on the device bottom to add it.

Method 3: Enter the device register code to add it.

Create Storage Pool

For the first time use, please create a storage pool first.

1. Tap to select the device in the device list.
2. Enter the storage pool name, select the redundancy mode as needed, and then select a hard drive to join in. Tap **OK**.

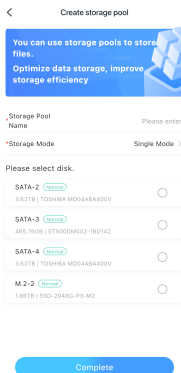

Now you can use the app to manage your NAS device anytime, anywhere.

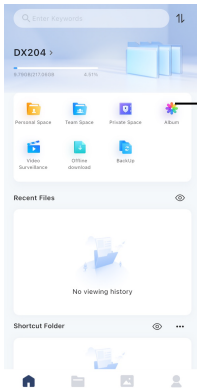

View files stored in NAS

2 Manage on Web

1. On your PC, go to Network > Other Devices to find the NAS device. Double-click it to open the browser and access the NAS management system login page.
2. Enter the default username and password to log in to the system. Then you can perform operations such as storage configuration management.



NOTE!

For the first time login, the default username/password is admin/admin. It is recommended to change the default password to a strong password: at least 9 characters including uppercase and lowercase letters, digits, and special characters. When changed, please use the modified password to log in.

For detailed instruction about using the NAS management system, please refer to the user manual.

4.2 Use GE2 Port

4.2.1 Connect Device to Network

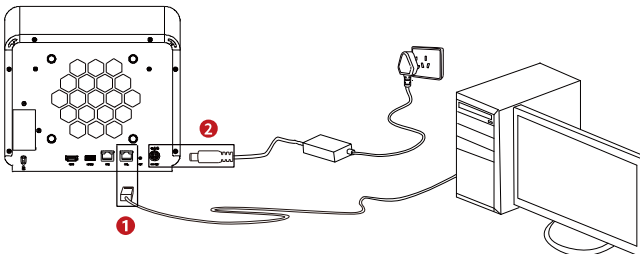

1. Connect the **GE2 port (right)** to the PC with a network cable.
2. Connect the power cable.
 - (1) Connect the power adapter to the device's power input interface, making sure the side with an arrow is facing up.

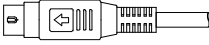

- (2) Connect one end of the power cable to the power adapter, and connect the other end to the AC power socket.
3. After connecting power, press the power button on the device. The power button is lit, which means the device is turned on.

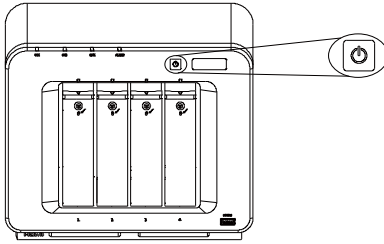

NOTE!

To turn off the device, press the power button once.

4. Change the PC's IP address to be in the same segment as GE2.
5. Visit <http://192.168.0.1> using Google Chrome on the PC. The NAS management system login page appears.
6. Enter the default username/password (admin/admin) to log in to the system.
7. Go to **Control Panel > System Settings > Network** to change the NAS device's IP to the Internet IP.
8. Connect the NAS device to a network device (e.g., switch, router) using a network cable. And then restore the PC's IP address to its original configuration.



NOTE!

For the first time login, the default username/password is admin/admin. It is recommended to change the default password to a strong password: at least 9 characters including uppercase and lowercase letters, digits, and special characters. When changed, please use the modified password to log in.

4.2.2 Initial Setup

Choose a method to complete the initial setup of the NAS.

1 Manage in App

For detailed instructions, please refer to [Manage in App](#).

2 Manage on Web

1. Visit **http://*modified IP*** using Google Chrome on the PC. The NAS management system login page appears.
2. Enter the actual username and password to log in to the system. Then you can perform operations such as storage configuration management.

For detailed instruction about using the NAS management system, please refer to the user manual.

Disclaimer and Safety Warnings

Copyright Statement

No part of this manual may be copied, reproduced, translated or distributed in any form or by any means without prior consent in writing from our company (referred to as us hereafter).

The product described in this manual may contain proprietary software owned by our company and its possible licensors. Unless permitted, no one is allowed to copy, distribute, modify, abstract, decompile, disassemble, decrypt, reverse engineer, rent, transfer, or sublicense the software in any form or by any means.

Trademark Acknowledgements



The terms HDMI, HDMI High-Definition Multimedia Interface, HDMI Trade dress and the HDMI Logos are trademarks or registered trademarks of HDMI Licensing Administrator, Inc.

All other trademarks, products, services and companies in this manual or the product described in this manual are the property of their respective owners.

Export Compliance Statement

Our company complies with applicable export control laws and regulations worldwide, including that of the People's Republic of China and the United States, and abides by relevant regulations relating to the export, re-export and transfer of hardware, software and technology. Regarding the product described in this manual, our company asks you to fully understand and strictly abide by the applicable export laws and regulations worldwide.

Privacy Protection Reminder

Our company complies with appropriate privacy protection laws and is committed to protecting user privacy. You may want to read our full privacy policy at our website and get to know the ways we process your personal information. Please be aware, using the product described in this manual may involve the collection of personal information such as face, fingerprint, license plate number, email, phone number, GPS. Please abide by your local laws and regulations while using the product.

About This Manual

- This manual is intended for multiple product models, and the photos, illustrations, descriptions, etc, in this manual may be different from the actual appearances, functions, features, etc, of the product.
- This manual is intended for multiple software versions, and the illustrations and descriptions in this manual may be different from the actual GUI and functions of the software.
- Despite our best efforts, technical or typographical errors may exist in this manual. Our company cannot be held responsible for any such errors and reserves the right to change the manual without prior notice.
- Users are fully responsible for the damages and losses that arise due to improper operation.
- Our company reserves the right to change any information in this manual without any prior notice or indication. Due to such reasons as product version upgrade or regulatory requirement of relevant regions, this manual will be periodically updated.

Disclaimer of Liability

- To the extent allowed by applicable law, in no event will our company be liable for any special, incidental, indirect, consequential damages, nor for any loss of profits, data, and documents.
- The product described in this manual is provided on an "as is" basis. Unless required by applicable law, this manual is only for informational purpose, and all statements, information, and recommendations in this manual are presented without warranty of any kind, expressed or implied, including, but not limited to, merchantability, satisfaction with quality, fitness for a particular purpose, and noninfringement.
- Users must assume total responsibility and all risks for connecting the product to the Internet, including, but not limited to, network attack, hacking, and virus. We strongly recommend that users take all necessary measures to enhance the protection of network, device, data and personal information. Our company disclaims any liability related thereto but will readily provide necessary security related support.
- To the extent not prohibited by applicable law, in no event will our company and its employees, licensors, subsidiary, affiliates be liable for results arising out of using or inability to use the product or service, including, not limited to, loss of profits and any other commercial damages or losses, loss of data, procurement of substitute goods or services; property damage, personal injury, business interruption, loss of business information, or any special, direct, indirect, incidental, consequential, pecuniary, coverage, exemplary, subsidiary losses, however caused and on any theory of liability, whether in contract, strict liability or tort (including negligence or otherwise) in any way out of the use of the product, even if our company has been advised of the possibility of such damages (other than as may be required by applicable law in cases involving personal injury, incidental or subsidiary damage).
- To the extent allowed by applicable law, in no event shall our total liability to you for all damages for the product described in this manual (other than as may be required by applicable law in cases involving personal injury) exceed the amount of money that you have paid for the product.

EU Authorised Representative

UNV Technology EUROPE B.V. Room 2945, 3rd Floor, Randstad 21-05 G, 1314 BD, Almere, Netherlands.

Network Security

Please take all necessary measures to enhance network security for your device.

The following are necessary measures for the network security of your device:

- **Change default password and set strong password:** You are strongly recommended to change the default password after your first login and set a strong password of at least nine characters including all three elements: digits, letters and special characters.
- **Keep firmware up to date:** It is recommended that your device is always upgraded to the latest version for the latest functions and better security. Visit our official website or contact your local dealer for the latest firmware.

The following are recommendations for enhancing network security of your device:

- **Change password regularly:** Change your device password on a regular basis and keep the password safe. Make sure only the authorized user can log in to the device.
- **Enable HTTPS/SSL:** Use SSL certificate to encrypt HTTP communications and ensure data security.
- **Enable IP address filtering:** Allow access only from the specified IP addresses.
- **Minimum port mapping:** Configure your router or firewall to open a minimum set of ports to the WAN and keep only the necessary port mappings. Never set the device as the DMZ host or configure a full cone NAT.
- **Disable the automatic login and save password features:** If multiple users have access to your computer, it is recommended that you disable these features to prevent unauthorized access.
- **Choose username and password discretely:** Avoid using the username and password of your social media, bank, email account, etc., as the username and password of your device, in case your social media, bank and email account information is leaked.
- **Restrict user permissions:** If more than one user needs access to your system, make sure each user is granted only the necessary permissions.
- **Disable UPnP:** When UPnP is enabled, the router will automatically map internal ports, and the system will automatically forward port data, which results in the risks of data leakage. Therefore, it is recommended to disable UPnP if HTTP and TCP port mapping have been enabled manually on your router.
- **SNMP:** Disable SNMP if you do not use it. If you do use it, then SNMPv3 is recommended.
- **Multicast:** Multicast is intended to transmit video to multiple devices. If you do not use this function, it is recommended you disable multicast on your network.
- **Check logs:** Check your device logs regularly to detect unauthorized access or abnormal operations.
- **Physical protection:** Keep the device in a locked room or cabinet to prevent unauthorized physical access.
- **Isolate video surveillance network:** Isolating your video surveillance network with other service networks helps prevent unauthorized access to devices in your security system from other service networks.

Safety Warnings

The device must be installed, serviced and maintained by a trained professional with necessary safety knowledge and skills. Before you start using the device, please read through this guide carefully and make sure all applicable requirements are met to avoid danger and loss of property.

Storage, transportation, and use

- Store or use the device in a proper environment that meets environmental requirements, including and not limited to, temperature, humidity, dust, corrosive gases, electromagnetic radiation, etc.
- Make sure the device is securely installed or placed on a flat surface to prevent falling.
- Unless otherwise specified, do not stack devices.
- Ensure good ventilation in the operating environment. Do not cover the vents on the device. Allow adequate space for ventilation.
- Protect the device from liquid of any kind.
- Make sure the power supply provides a stable voltage that meets the power requirements of the device. Make sure the power supply's output power exceeds the total maximum power of all the connected devices.
- Verify that the device is properly installed before connecting it to power.
- Do not remove the seal from the device body without consulting our company first. Do not attempt to service the product yourself. Contact a trained professional for maintenance.
- Always disconnect the device from power before attempting to move the device.
- Take proper waterproof measures in accordance with requirements before using the device outdoors.

Power Requirements

- Install and use the device in strict accordance with your local electrical safety regulations.
- Use a UL certified power supply that meets LPS requirements if an adapter is used.
- Use the recommended cordset (power cord) in accordance with the specified ratings.
- Only use the power adapter supplied with your device.
- Use a mains socket outlet with a protective earthing (grounding) connection.
- Ground your device properly if the device is intended to be grounded.

Battery Use Caution

- When battery is used, avoid:

- Extremely high or low temperature and air pressure during use, storage and transportation;
- Battery replacement.
- Use the battery properly. Improper use of the battery such as the following may cause risks of fire, explosion or leakage of flammable liquid or gas.
 - Replace battery with an incorrect type;
 - Dispose of a battery into fire or a hot oven, or mechanically crushing or cutting of a battery;
- Dispose of the used battery according to your local regulations or the battery manufacturer's instructions.

Avertissement de l'utilisation de la batterie

- Lorsque utiliser la batterie, évitez:
 - Température et pression d'air extrêmement élevées ou basses pendant l'utilisation, le stockage et le transport.
 - Remplacement de la batterie.
- Utilisez la batterie correctement. Mauvaise utilisation de la batterie comme celles mentionnées ici, peut entraîner des risques d'incendie, d'explosion ou de fuite liquide de gaz inflammables.
 - Remplacer la batterie par un type incorrect;
 - Disposer d'une batterie dans le feu ou un four chaud, écraser mécaniquement ou couper la batterie;
- Disposer la batterie utilisée conformément à vos règlements locaux ou aux instructions du fabricant de la batterie.

Regulatory Compliance

FCC Statements

This device complies with Part 15 of the FCC Rules. Operation is subject to the following two conditions: (1) this device may not cause harmful interference, and (2) this device must accept any interference received, including interference that may cause undesired operation.

Caution: The user is cautioned that changes or modifications not expressly approved by the party responsible for compliance could void the user's authority to operate the equipment.

NOTE: This equipment has been tested and found to comply with the limits for a Class A digital device, pursuant to part 15 of the FCC Rules. These limits are designed to provide reasonable protection against harmful interference when the equipment is operated in a commercial environment. This equipment generates, uses, and can radiate radio frequency energy and, if not installed and used in accordance with the instruction manual, may cause harmful interference to radio communications. Operation of this equipment in a residential area is likely to cause harmful interference in which case the user will be required to correct the interference at his own expense.

LVD/EMC Directive



This product complies with the European Low Voltage Directive 2014/35/EU and EMC Directive 2014/30/EU.

WEEE Directive-2012/19/EU



The product this manual refers to is covered by the Waste Electrical & Electronic Equipment (WEEE) Directive and must be disposed of in a responsible manner.

Battery Regulation- (EU) 2023/1542



Battery in the product complies with the European Battery Regulation (EU) 2023/1542. For proper recycling, return the battery to your supplier or to a designated collection point.