

## Single-Door Access Controller

### OER-601



## Overview

The single-door access controller features high performance and high reliability. It is designed with TCP/IP wired network communication interface and features specialized access control management functions, suitable for various complex access control scenarios.

## Features

- ARM processor provides high concurrent processing speed.
- Supports network transparent transmission.
- Supports storage battery connection.
- Supports fire alarm linkage for enhanced security.
- Supports multiple authentication methods, including card, password, card&password, and QR code.
- Supports up to 200,000 cards and 300,000 events storage.
- Supports connecting to EZAccess platform ( Only permission issuance is supported ) , UNV Guard server.
- Supports device configuration through the web interface.
- Built-in door lock power supply, no additional power supply required.
- Supports door magnet detection.
- Supports local saving during the network interruption and resuming interrupted data when the network reconnects.
- Supports anti-passback, door opening with first card, and door opening with duress password.

## Specifications

Model	OER-601
Specification Index	
Card Capacity	Common card + personnel password: 200,000 Duress card + duress password: 1,000Other cards: 100

Event Capacity	300,000
Time Template	256
Holiday Template	256
Check Template	Supports up to 16 check templates configured by weekly schedule, up to 8 time periods per day, and up to 3 authentication modes per time period
Basic Business	
Communication Mode	TCP/IP
Hardware Specification	
Network Interface	1 x 100Mbps Ethernet interface
Number Of Controllable Door	1
Wiegand Interface	2 x Wiegand input
RS485 Interface	4
IO Input	1 x fire input, 4 x zone input, 2 x case input
IO Output	2
Power Output	2 x DC12V (maximum current for door lock: 5A, for card reader: 1.5A)
Door Lock Interface	1 x door lock control (NC+/NO+/COM) 1 x door magnet, 1 x exit button
Tamper Button	Support
Application	Indoor
Operating Temperature	-30°C to 65°C
Rated Input Voltage	AC100V to AC240V (50/60Hz)
Spare Power Supply	DC12V/7AH, user-prepared
Air Circuit Breaker	Built-in
Mount Method	Wall mount
Indicator	Power indicator: Steady red when the device is connected to power Operation indicator: Blinks green when the operation is normal Door lock indicator: Steady green when the lock is open Fault indicator 485 indicator Charging indicator Network indicator
Dimensions (L x W x H)	342mm*325.5mm*88mm
Weight	3300g

## Ordering Info

Product Model	Description
OER-601	Single Door Access Controller

## Dimensions

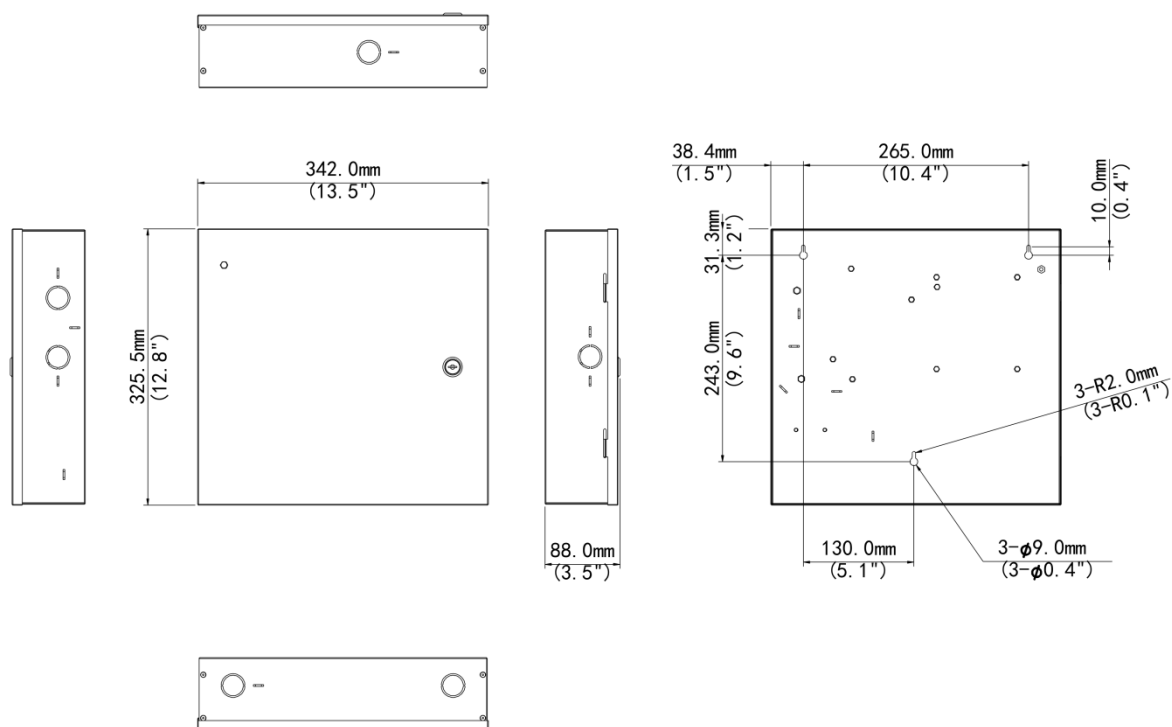

### Zhejiang Uniview Technologies Co., Ltd.



<http://www.uniview.com>



[overseasbusiness@uniview.com](mailto:overseasbusiness@uniview.com); [globalsupport@uniview.com](mailto:globalsupport@uniview.com)



No. 369, Xietong Road, Xixing Sub-district, Binjiang District, Hangzhou City, 310051, Zhejiang Province, China  
(Zhejiang) Pilot Free Trade Zone, China



©2023-2025 Zhejiang Uniview Technologies Co., Ltd. All rights reserved.

\*Product specifications and availability are subject to change without notice.

\*Despite our best efforts, technical or typographical errors may exist in this document.

Uniview cannot be held responsible for any such errors and reserves the right to change the contents of this document without prior notice.