

1.25G Single-Mode 10KM SFP Optical Transceiver SFP-GE-LX-SM1310



Specifications

Model	SFP-GE-LX-SM1310-IN
Hardware Specification	
Data Transfer Rate	1.25Gbps
Wavelength	1310nm
Transmission Distance	10km
Optical Output Power	-3dBm to -9dBm
Connector	LC Connector, Single Mode, Dual-Fiber
Operating Temperature	0 to 70 °C

Dimensions

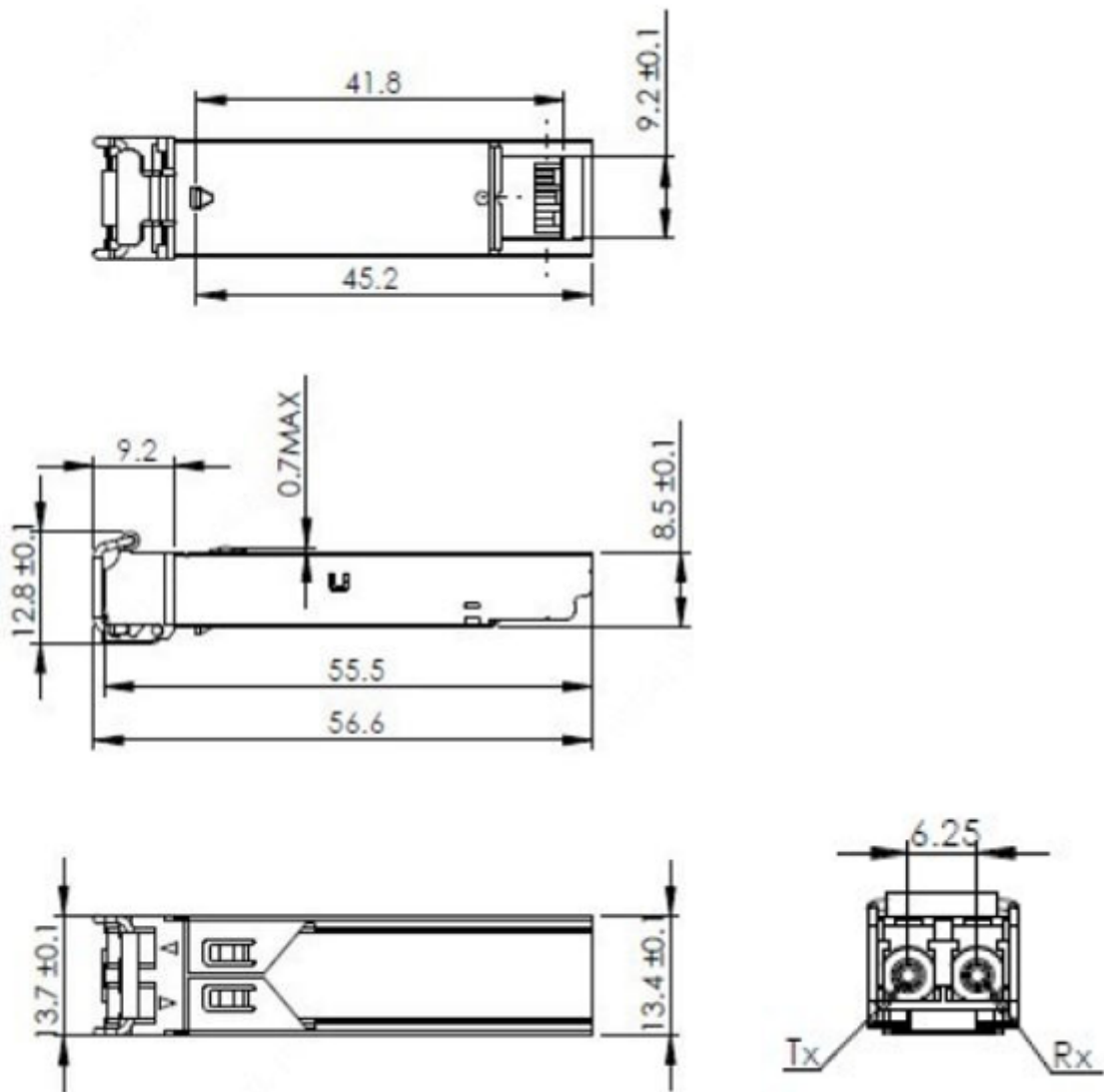

Unlimited New View

Zhejiang Uniview Technologies Co., Ltd.

 <http://www.uniview.com>

 overseasbusiness@uniview.com; globalsupport@uniview.com

 No. 369, Xietong Road, Xixing Sub-district, Binjiang District, Hangzhou City, 310051, Zhejiang Province, China



©2023-2025 Zhejiang Uniview Technologies Co., Ltd. All rights reserved.

*Product specifications and availability are subject to change without notice.

Despite our best efforts, technical or typographical errors may exist in this document. Uniview cannot be held responsible for any such errors and reserves the right to change the contents of this document without prior notice.